

SAINT-GOBAIN ISOVER KOREA

Glass Wool

Sustainable Insulation Solution





*We care about building better
for people and the planet!*





Contents

04	ISOVER Introduction	24	Safe Roll 4+ Duct
06	ISOVER Glass Wool	26	Safe Cover
08	WeatherProof BLACK	28	Green Mat
10	WeatherProof	30	Cryolene
12	E·Saver	32	Mineral Wool Sillatherm
14	Safe Roll	34	Energy Saver
16	Safe Wall	36	Vario
18	Safe Board	38	Ecophon
20	Sound Safe Board	40	Certifications
22	Safe Panel Board	42	References

SAINT-GOBAIN ISOVER KOREA



Copyright: ©Shutterstock

We produce about 30,000 tons of glass wool annually with the latest TEL process.

30,000 Ton · Year

Starting with production at the Incheon plant in 1986, Saint-Gobain Isover Korea specialized in glass wool products, improved quality and strengthened competitiveness, and completed the construction of the Dangjin plant, the largest in Korea, in 2004. It was reborn as a company specializing in glass wool in name and reality.

As a global leader with the world's No. 1 market share, through the successful merger of the Saint-Gobain Group, Saint-Gobain Isover Korea supplies world-class quality products as a member of the global network.



ISOVER History

- 1985** Completion of 1st Incheon Plant Glass Wool
- 1986** Acquisition of artificial mineral wool insulation standard
- 1994** Establishment of HanKuk Haniso
- 1999** ISO 9002
- 2000** Europe CE Certificate
- 2003** ISO 9001
- 2004** Dangjin Plant Completion
- 2005** Acquisition of Hankuk Haniso by Saint-Gobain
- 2012** ISO 14001
- 2015** Saint-Gobain 350th Anniversary
- 2018** Corporate name changed to Saint-Gobain Isover Korea from Hankuk Haniso
- 2021** ISO 45001

Making The World A Better Home!

SAINT-GOBAIN



Copyright: ©Sergio Grazia / Valode&Pistre

350 Year · History

Saint-Gobain group, a world leader in sustainable construction, designs, manufactures and distributes materials and services for the construction and industrial markets.

Saint-Gobain's integrated solutions for renovation, lightweight building, construction and decarbonization of industry are developed through a continuous innovation process and deliver sustainability and performance.

As a global leader with the largest market share in the world, 170,000 employees in 75 countries provide the best solutions and achieve approximately KRW 60 trillion in sales.

2050 NET ZERO CARBON



CLIMATE



- Net Zero Carbon 2050

- Top Employer Global for 8 years in a row

- Top 100 Global Innovator over 10 years

- CDP Climate "A" List

- Bloomberg Gender Equality Index 2022

ISOVER Glass Wool



Our goal for Sustainable Solutions **Our action for Net Zero Carbon 2050!**

Isover glass wool enables permanent cooling and heating energy savings with a single application.

Isover glass wool has a high percentage of recycled glass (more than 70%), protecting our limited natural resources and taking the lead in efficient resource recycling.

Isover's advanced technology contributes to the prevention of water pollution by reprocessing and using wastewater generated in the process.



Effective Fire Protection

As a non-combustible material, no fire propagation, neither poisonous gas.



Thermal Insulation

Low thermal conductivity & excellent warming effect.



Acoustic Insulation

Excellent sound absorption effect with fine fiber structure.



Easy Installation

Light & Flexible.



Harmless to Humans

Work & Live with mineral materials.



Water Resistance

Water-repellent treatment does not reduce insulation performance due to moisture and water-repellent is fast.



Durable

As an inorganic product, it has excellent water resistance, chemical resistance, and earthquake resistance.



Cost Effectiveness

Permanent heating and cooling cost savings with just one installation.



ISOVER
WeatherProof BLACK



©Grande Arche La Défense, Paris, France

WeatherProof BLACK

WeatherProof BLACK complies with the revised building regulations, 'securing flame retardant performance of each material above semi-fluorescent', and both black facing and insulation are non-combustible, making it the only external insulation material that meets the current standard.



Application

- Dry external insulation open joint system for walls and roofs



Effective Fire Protection

Certified the non-combustible performance test with the incombustible facing woven from glass fiber raw materials attached to the glass wool insulation.



Water Resistance

Water-repellent treatment minimizes moisture penetration. Prevents degradation of insulation performance under external insulation conditions.



Thermal Insulation

Excellent insulation performance.



Acoustic Insulation

Excellent sound absorption effect with fine fiber structure.

Breathable facing

Non-combustible glass wool with water repellency

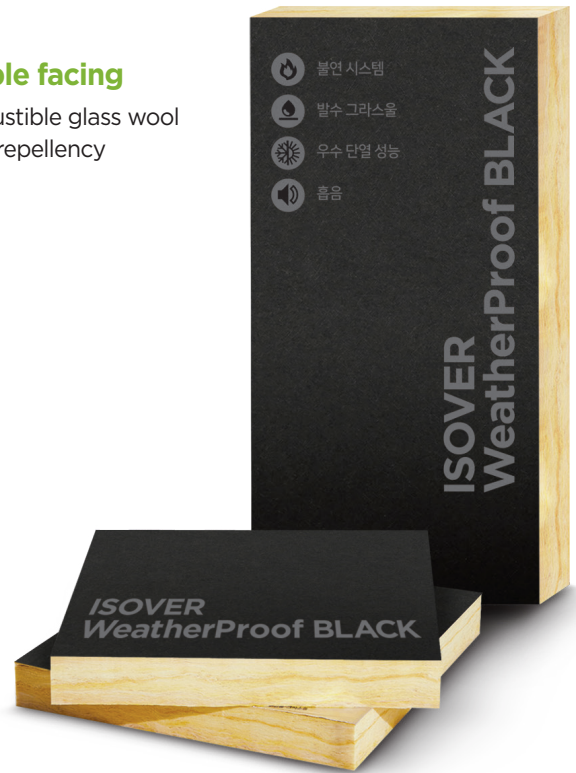

WeatherProof BLACK Solutions



Black non-combustible Fastener, Black Cap,

Black Sealing Tape

Track

Knife

References

Grande Arche La Défense in France



1

Open Joint System



2

CS WIND HQ in Seoul



3

Specification

Product	Insulation grade	Fire class	Density	Thermal conductivity(W/mk)	Manufacture spec.	
ISOVER			kg/m ³	Measurement	KS	Thickness(mm) W x L(m)
WeatherProof BLACK 34	A	Non-combustible (Incl. Facing)	40	0.034	≤ 0.035	- 200
WeatherProof BLACK 33			48	0.033	≤ 0.034	- 160
WeatherProof BLACK 32			48	0.032	≤ 0.034	- 125

※ CAUTION : BLACK tissue is the same material as glass wool, and can be torn by sharp objects or strong impact. Be careful not to throw or step on it when unloading or carrying it.



©Gangbuk (samsung hospital)

WeatherProof

WeatherProof is a product exclusively for external insulation developed to prevent moisture penetration from the outside air and to discharge moisture inside the glass wool.



Application

- Areas of dry external insulation of walls and roofs



Water Resistance

Water-repellent treatment minimizes moisture penetration. Prevents degradation of insulation performance under external insulation conditions.



Breathable / Waterproof

Micropores that are smaller than water droplets prevent water penetration and allow moisture to pass through to release moisture from glass wool. In addition, it blocks radiant heat from the aluminum surface to maximize insulation performance.



Fastener

Improved glass wool sagging by developing exclusive fastener cap.

Breathable perforated foil facing (semi-incombustible)

Non-combustible glass wool with water repellency



WeatherProof Solutions



References

Godeok Central PRUGIO in Seoul



1

Marina G7 in Busan



2

KB IT Center in Gimpo



3

Specification

Product	Insulation grade	Fire class	Density	Thermal conductivity(W/mk)	Manufacture spec.	
ISOVER			kg/m ³	Measurement	KS	Thickness(mm) W x L(m)
WeatherProof 34	A	Non-combustible (Core)	40	0.034	≤ 0.035	- 200
WeatherProof 33			48	0.033	≤ 0.034	- 160
WeatherProof 32			48	0.032	≤ 0.034	- 125

※ Guaranteed semi-nonflammable performance when moisture permeable waterproof silver foil is attached.



@Songdo convensia

E · SAVER

Maximized insulation performance through continuous research and development, only 24K 'A' grade, high-performance product in Korea.



Reduction of transportation
& storage cost

Application

- Insulation of internal and external walls and roofs of buildings
- Core of external insulation panel
- Industrial plant insulation
- Sound absorption, thermal insulation for ship & train



Thermal Insulation / Light Weight

Density 24kg/m² can reduce the weight of insulation in a building by half while maintaining grade insulation performance.



Water Resistance

Water-repellent treatment minimizes moisture penetration. Prevents degradation of insulation performance under external insulation conditions.



Easy Installation

By applying soft touch technology, fibers are soft and scattering dust is minimized, improving workability innovatively.



References

Songdo convensia



1

Yeouido parkone 2



2

Specification

Product	Insulation grade	Density	Thermal conductivity 20°C(W/mk)		Thickness	Width	Length	Type
ISOVER		kg/m ²	E·SAVER	KS	mm	m	m	
E·SAVER	A	24	0.034	≤ 0.037	25	1	20	Roll/Board
					50		10	
					75		7	
					- 240	Consulting		
		32	0.032	≤ 0.036	- 140	1	2	Board

※ Contact the CS center for other specifications and facing materials.

ISOVER SAFE ROLL



Copyright: ©Shutterstock

SAFE ROLL

It has excellent insulation, heat preservation, sound absorption, easy to install and prevents condensation by attaching silver foil or vapor barrier to one side.



Optimise Your Logistics
Reduction of transportation
& storage cost

Application

- Insulation materials for building ceilings, roof, walls, etc.
- Thermal insulation for construction(duct), industrial(tank)
- Thermal & sound insulation for boiler, fire door, vehicles and ships.
- Thermal insulation for agricultural (shed, greenhouse, warehouse, etc.)



Thermal Insulation
Excellent insulation performance.



Compressed Packaging
Enables economical storage & transportation.



Acoustic Insulation
Excellent sound absorption effect with fine fiber structure.



Safe Roll Surface

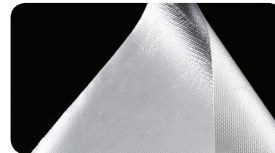

Silver Foil

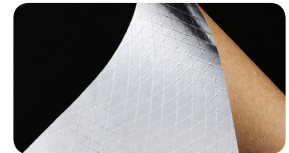

Vapor Barrier

References

Easy To Transportation



1

Safe Roll Applied Interior



2

Copyright: ©Shutterstock

Specification

Product	Standard spec.				Thermal conductivity(W/mk)				Hot shrinkage temp. ℃	Certification
	Density kg/m ³	Thickness mm	Width m	Length m	Measurement		KS			
ISOVER					20℃	70℃	20℃	70℃		
SAFE ROLL	24	25	1	20	0.035	0.045	≤ 0.037	≤ 0.048	≥ 300℃	KS L 9102 JIS A 9504
		50		10						
		75		7						

※ Possible up to 1.2m in width, Contact the CS center for other spec.
 ※ Attachable of silver kraft paper, vapor barrier, etc.

ISOVER SAFE WALL



Copyright: ©Shutterstock

SAFE WALL

For partition walls (Dry wall) in apartments and general buildings. It does not require a separate moisture barrier as it is a spore-free product made of glass wool covered by PE film, and it is a product that is easy to install as it is manufactured in the same size as the width of a lightweight steel stud.



Optimise Your Logistics
Reduction of transportation
& storage cost

Application

- Insulation and sound absorption material for apartment walls and ceilings, internal and external walls of general buildings



Thermal Insulation
Excellent insulation performance.



Easy Installation
Spore-free product made of glass wool covered by PE film & easy to install.



Acoustic Insulation
Excellent sound absorption effect with fine fiber structure.



References

Safe Wall Installation



1

Safe Wall Applied Interior



2

Copyright: ©Shutterstock

Specification

Product	Density	Thickness	Width	Length	Thermal conductivity(W/mk)				Certification	Remark
					Measurement		KS			
ISOVER	kg/m ³	mm	m	m	20C	70C	20C	70C		
SAFE WALL	24K	25 - 120	0.45 - 0.9	1 - 2.6	0.035	0.045	≤ 0.037	≤ 0.048	KS L 9102 JIS A 9504	PE film wrapping

※ Contact the CS center for other spec.

ISOVER SAFE BOARD



Copyright: ©Shutterstock

SAFE BOARD

As a thin and uniform fiber diameter, it has low thermal conductivity. Excellent insulation and heat preservation effects as well as sound absorption due to the formation of fine continuity voids.

Application

- Insulation material for building wall, ceiling, basement, curtain wall, etc.
- Insulation for building and industrial thermal equipment.(duct & tank)
- Thermal & acoustic insulation for ship, trains, automobile, etc.
- Sound absorbing materials for road and railway noise barrier.



Thermal Insulation
Excellent insulation performance



Effective Fire Protection
No fire propagation, neither poisonous gas.



Acoustic Insulation
Excellent sound absorption effect with fine fiber structure.



References

Safe Board Installation



1

Safe Board Applied Interior



2

Safe Board Applied Train



3

Copyright: ©Shutterstock

Specification

Product	Density	Thickness	Width	Length	Thermal conductivity(W/mk)				Hot shrinkage temp.	Certification	
					Measurement		KS				
ISOVER	kg/m ³	mm	m	m	20°C	70°C	20°C	70°C	°C		
SAFE BOARD	32	50	1	2	0.034	0.041	≤ 0.036	≤ 0.045	≥ 300°C	KS L 9102 JIS A 9504	
	40					0.033	0.041	≤ 0.035	≤ 0.043		≥ 350°C
	48				0.040		≤ 0.034	≤ 0.042			
	64				0.032	0.039	≤ 0.034	≤ 0.042	≥ 400°C		
	80										
	96										

- ※ Attachable of glass cloth, silver kraft, aluminum foil, tissue, PVF, etc.
- ※ Possible up to 1.2m in width.
- ※ Contact the CS center for other spec.

ISOVER SOUND SAFE BOARD



©Laurent Kronental / Valode&Pistre

SOUND SAFE BOARD

Due to the formation of a continuity gap, sound stays between the glass fibers and disappears in the form of heat, so it has excellent sound absorption, and a variety of glass cloth colors can be selected to finish considering aesthetics and economy.

Application

- Sound absorbing material in the building.
- Building and industrial heat facilities (machine rooms, air-conditioning rooms, etc.) sound-absorbing finishing materials.
- Sound-absorbing insulation materials for broadcasting rooms, sound facilities, gymnasiums, etc.



Thermal Insulation
Excellent insulation performance



Easy Installation
Various finishing materials & easy to install



Acoustic Insulation
Excellent sound absorption effect with fine fiber structure



References

Sound Safe Board Samples



1

Noise Prevention



Copyright: ©Shutterstock

2

Acoustic Sounds

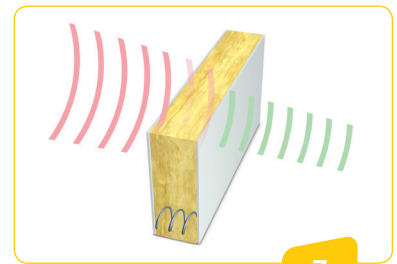

3

Specification

Product	Standard spec.				NRC	Certification	Remark
ISOVER	Density(kg/m ³)	Thickness(mm)	Width(m)	Length(m)	KS		
SOUND SAFE BOARD	32	50	1	2	≥ 0.81	KS F 3503	Glass wool + Glass cloth finishing
	40						
	48						
	64						
	80						
	96				0.89		

- ※ Glass cloth: A fiber woven from fiber glass yarn, used as a surface finish.
- ※ Colors of class cloth: Grey, White, Black, Gravel.
- ※ Contact the CS center for other spec.

ISOVER SAFE PANEL BOARD



Copyright: ©Shutterstock

SAFE PANEL BOARD

As a core material for sandwich panels and has improved processability by increasing strength.

A non-combustible material that has obtained certification for fire-resistance structure. It does not burn, so there is no fear of flame propagation, and no toxic gas is generated in case of fire, minimizing human life and property damage.

Application

- Core material of sandwich panels for walls and roofs
- Core material of sandwich panels for internal and external walls and partitions



Thermal Insulation
Excellent insulation performance.



Effective Fire Protection
No fire propagation, neither poisonous gas.



References

Safe Panel Board Application

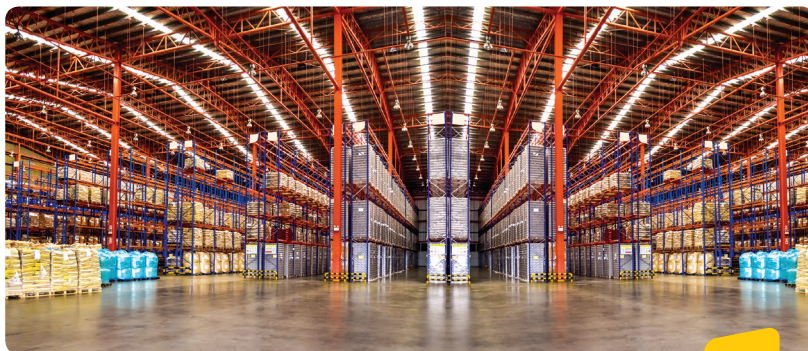

©Saint-Gobain

1

Safe Panel Board Cross Section

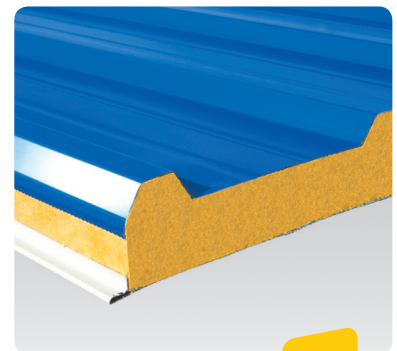

2

Specification

Product	Density	Thermal conductivity(W/mk)		Hot shrinkage temp.	Certification
ISOVER	kg/m ³	20°C	70°C	°C	
SOUND PANEL BOARD	48K	0.034	0.042	≥ 300°C	KS L 9102 JIS A 9504
	64K	0.033	0.040	≥ 400°C	

※ Contact the CS center for other spec.



Copyright: ©Shutterstock

SAFE ROLL 4+ Duct

Safe roll 4+ duct is eco-friendly by using natural binders, provide work convenience and innovatively reduce construction time and labor cost.



Optimise Your Logistics
Reduction of transportation
& storage cost

Application

- Thermal insulation materials for construction and industrial use.
- Partition walls for apartments and general buildings.



Thermal Insulation
Excellent insulation performance.



Compressed Packaging
Enables economical storage & transportation.



Acoustic Insulation
Excellent sound absorption effect with fine fiber structure.



References

Safe Roll 4+ Duct

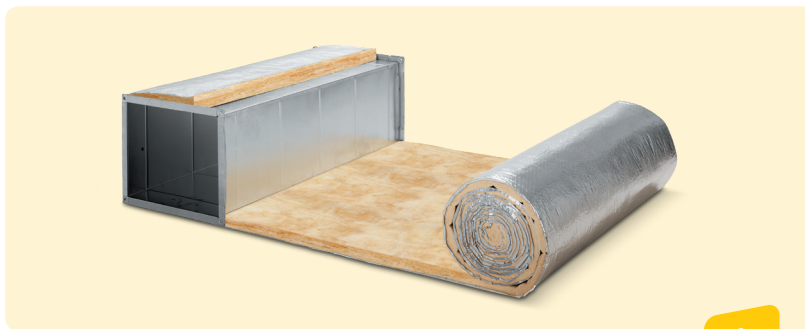

Safe Roll 4+ Duct



Specification

Product	Standard spec.				Thermal conductivity(W/mk)				Hot shrinkage temp.	Certification
	Density	Thickness	Width	Length	Measurement		KS			
ISOVER	kg/m ³	mm	m	m	20°C	70°C	20°C	70°C	°C	
SAFE ROLL 4+ Duct	24	25	1	20	0.035	0.045	≤ 0.037	≤ 0.048	≥ 300°C	KS L 9102 JIS A 9504
			1.4							

※ Possible up to 1.4m in width.

※ Contact the CS center for other spec.

ISOVER SAFE COVER



Copyright: ©Shutterstock

SAFE COVER

Easy to install by attaching kraft or vapor barrier to the surface, and the appearance is neat because the density is uniform and there is no thickness variation.

Application

- Insulation for building and industrial plumbing facilities.



Easy Installation

Safe Cover - Kraft
Easy construction by applying kraft on the outer surface.

Safe Cover - Vapor barrier
Aluminum silver foil on the outer surface is reinforced with diamond-shaped yarn to prevent wrinkles and increase strength.



Effective Fire Protection

No fire propagation, neither poisonous gas.



References



Specification

Pipe	Standard spec.		Density kg/m ³	Thickness mm	Thermal conductivity(W/mk)				Hot shrinkage temp. °C	Certification
	mm	inch			Measurement		KS			
ISOVER					20°C	70°C	20°C	70°C		
PIC 15	15	1/2	55, 65	25, 40, 50	0.032	0.040	≤ 0.036	≤ 0.043	≥ 350°C	KS L 9102 JIS A 9504
PIC 20	20	3/4								
PIC 25	25	1								
PIC 32	32	1 1/4								
PIC 40	40	1 1/2								
PIC 50	50	2								
PIC 65	65	2 1/2								
PIC 80	80	3								
PIC 100	100	4								
PIC 125	125	5								
PIC 150	150	6	40, 50							
PIC 200	200	8								
PIC 250	250	10								
PIC 300	300	12								
PIC 350	350	14								
PIC 400	400	16								
PIC 450	450	18								

※ Contact the CS center for other spec.

ISOVER GREEN MAT



Copyright: ©Shutterstock

GREEN MAT

As non-hardening glass wool raw material and processed in various ways as a sound-absorbing insulation material for automobiles, shipbuilding, and railroad vehicles.

Application

- Sound absorbing insulation materials for automobiles, shipbuilding, railroad vehicles, etc.



Thermal Insulation
Excellent insulation performance.



Effective Fire Protection
No fire propagation, neither poisonous gas.



Acoustic Insulation
Excellent sound absorption effect with fine fiber structure.

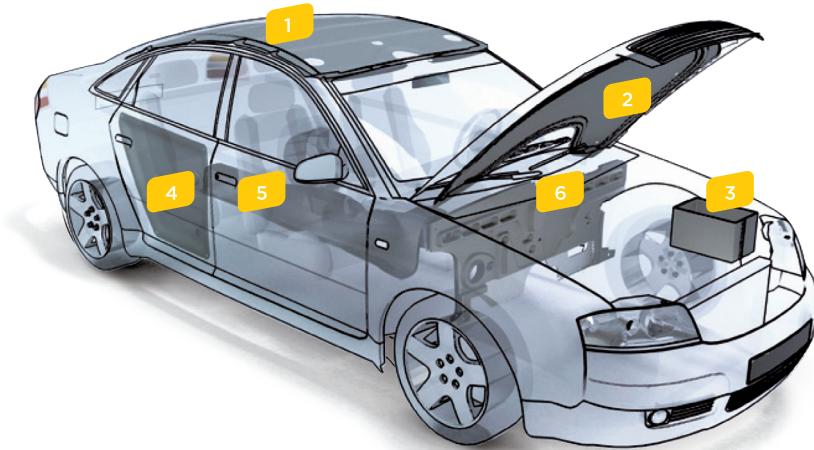

1 Head Liner



2 Hood Liner



3 Battery Cover



4 Door Panel



5 Tunnel



6 Dash Outer



Specification

Product	Unit weight	Width	Length
ISOVER	g/m ²	m	m
GREEN MAT	600 - 1,200	0.95 - 1.35	- 14

※ Contact the CS center for other spec.



©Kogas (Korea Gas Corporation)

CRYOLENE

ISOVER has developed the unique CRYOLENE solution with resilience as a high elasticity product for the insulation of cryogenic LNG tank walls, suspended decks and pipe connections.



Optimise Your Logistics
Reduction of transportation
& storage cost



Application

- Thermal Insulation for LNG Tank



Thermal Insulation
Excellent insulation performance.



Elasticity
No pressing or sagging after application.



Effective Fire Protection
No fire propagation, neither poisonous gas.



References

KOGAS Pyeongtaek in S. Korea



1

Cryolene



2

Specification

Product	Tolerance	Certification	CRYOLENE 681	CRYOLENE 682	CRYOLENE 684
CRYOLENE			Deck section	Wall section	Pipe section
Thickness (mm)	-	KS L 9102	50 - 150 (- 0 + 15mm)	50 - 150 (- 0 + 15mm)	50 - 100 (- 0 + 5mm)
Thickness (mm)	± 5mm		1.2 - 2.2		
Thickness (mm)	- 0 + 200mm		depends on facing / thickness		

※ Facing : Glass tissue(VV), Aluminium foil(A.A)
 ※ Contact the CS center for other spec.

ISOVER MINERAL WOOL SILLATHERM



Copyright: ©Shutterstock

MINERAL WOOL SILLATHERM

EIFS (Exterior Insulation and Finishing System) is a non-combustible mineral wool insulation material that maximizing the insulation performance of the external wall of the building, reducing heating and cooling energy cost.

Sillatherm is a product coated on one side, and it does not require pre-coating and curing work on site, which can reduce materials, construction cost and construction time.



Application

- EIFS (Exterior Insulation and Finishing System), a non-combustible mineral wool insulation



Effective Fire Protection

As a non-combustible system, it is safely protected with the best fire prevention.



Acoustic Insulation

Excellent sound absorption effect with fine fiber structure.



Thermal Insulation

Excellent insulation performance.



Water Resistance

Keep the wall dry according to water repellency and diffusivity of moisture.



Easy Installation

Pre-coated, no curing work required.



References

Chungnam passive house
120K 100mm



1

Gyeongju Hyeon-gok house
120K 60mm



2

Yesan house
120K 100mm



3

Goyang passive house
120K 60mm



4

Specification

Product	Standard spec.				Thermal conductivity(W/mk) Measurement	Hot shrinkage temp.	Certification	Remark
	Density	Thickness	Width	Length				
ISOVER	kg/m ³	mm	m	m	20℃	℃		
MINERAL WOOL SILLATHERM	120K	40 - 240	0.625	0.8	0.034	654	KS L 9102	External wall sound insulation performance improved by up to 4db Permanent insulation and dimensional stability

※ Contact the CS center for other spec.

ISOVER ENERGY SAVER



©Saint-Gobain ISOVER

ENERGY SAVER

It has excellent mechanical strength, so it can stand on its own without auxiliary fixing devices such as staples, and it does not sag or run down due to its water repellent performance even in harsh conditions where moisture can inevitably penetrate.

Application

- Thermal insulation of internal and external walls and roofs of wooden houses



Thermal Insulation
Excellent insulation performance.



Elasticity
No pressing or sagging after application.



Water Resistance
Keep the wall dry according to water repellency and diffusivity of moisture.



References

Energy Saver Application



1

Internal Thermal Bridge Blocking



2

External Thermal Bridge Blocking



3

Specification

Area	Insulation grade	Use	R-value	Thickness	Width	Length	pcs/bag	Constructed area	
ISOVER				mm	mm	mm		m ² /pcs	m ² /bag
Internal wall External wall	A	Wooden house	R15	90	375	2,460	9	0.92	8.30
			R23	140	375	2,460	6	0.92	5.54
R37			220	375	1,200	12	0.45	5.40	
Roof			R37	220	580	1,200	8	0.69	5.47
			R40	240	375	1,200	12	0.45	5.40
			R40	240	580	1,200	8	0.69	5.47
			Thermal bridge blocking	R7	40	575	1,200	24	0.69

※ Contact the CS center for other spec.



VARIO

Vario® System consists of two intelligent membranes, accessory tapes and a sealant, designed to adapt to the climate and protect your building, inside and out. The system is also designed with an uncompromising commitment to superior airtightness.



1 Vario XtraSafe
The intelligent membrane
for greater safety

2 Vario XtraFix
Membrane adhesive band

3 Vario XtraTape
Durable adhesive tape

4 Vario XtraFit
Strong elastic adhesive sealant

Application

- Airtight construction and condensation prevention for external walls and roofs of buildings



Easy Installation

Revolutionary new installation system with Xtra membrane and Xtra tape with apply and release function - no need for staples.



Energy Efficiency

Air-conditioning and heating energy can be saved by maximizing airtight performance.



Air Tightness

Creates an airtight barrier to lock out draught and keep in heat.



Execution method

Attaching the XtraFix to a hard surface



1

Attaching XtraSafe on XtraFix



2

Attaching of the film joint by XtraTape



3

Air tightening by XtraFit

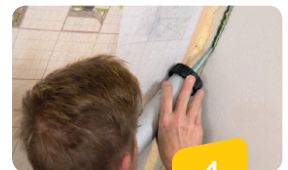

4

product introduction

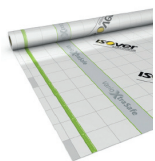

VARIO XtraSafe

Intelligent membrane (Airtightness, Thermal bridge)

Length	Width	Constructed area
40m	1.5m	60m ² / roll



VARIO XtraFix

Velcro type membrane adhesive tape (Airtightness)

Length	Width	Packing unit
25m	10mm	20 roll



Vario XtraTape

Single sided adhesive tape for overlapping membrane seams (Airtightness)

Length	Width	Packing unit
40m	60mm	5 roll



VARIO AntiSpike

Foam gasket tape (Watertightness, Thermal bridge)

Length	Width	Constructed area
20m	40mm	5 roll



VARIO INTEGRA

External house wrap membrane (Watertightness)

Length	Width	Constructed area
50m	1.5m	75m ² / roll



VARIO MultiTape

Double-sided strong adhesive tape for windows or pipes joint (Airtightness)

Length	Width	Packing unit
25m	60mm	10 roll



VARIO XtraFit

Strong elastic adhesive sealant (Watertightness)

Packing type	Volume	Packing unit
Cartridge	310ml	12 ea



VARIO Bond 100/150

Single sided adhesive tape for windows or doors (Airtightness)

Product	Length	Width
VARIO Bond 100	25m	100mm
VARIO Bond 150	25m	150mm



©Ecophon, Bartosz Makowski

ECOPHON

Ecophon provides premium acoustic solutions using differentiated ceiling and wall panels with the motto of nature where headquarter in Helsingborg, Sweden.

Ecophon solutions are exclusively supplied in Korea through Saint-Gobain Isover Korea.

ECOPHON SOLO

Ecophon Solo is a free hanging sound absorption product that can be installed on the ceiling in various shapes and colors.

- Open ceiling installation for cafe, restaurant, lobby without T-bar



©Ecophon, Hans Georg Esch



National Children's Museum

ECOPHON FOCUS

Various edge designs, shapes, levels and application options available.

- Applicable to products such as lighting, ventilation, and speakers
- Acoustic solutions for indoor activities such as offices, hospitals, and classrooms



©Ecophon, Studio e



Daegu Expo Exhibition Center

ECOPHON AKUSTO WALL

Ecophon wall is a sound absorption solution installed on the wall, not the ceiling.

- Use as an additional complement to ceiling acoustics
- Various size and design
- For School, office, sports facilities



©Ecophon, Patrick Klemm, Partone



©Ecophon, Bartosz Makowski

ECOPHON ADVANTAGE

High sound absorption solution product with high value for money.

- Light and easy installation with limited size
- For wide office space, school, sound room

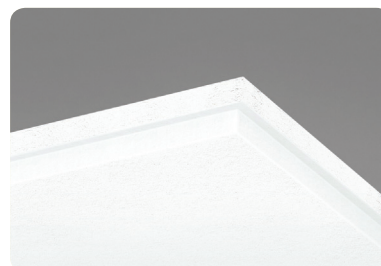

©Ecophon

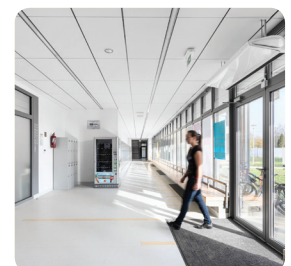

©Ecophon, Tomasz Osiak

Certifications

The products of Isover have been recognized for safety in the environment, quality, and fire by accredited certification by domestic and international agencies.



Eco-Lable

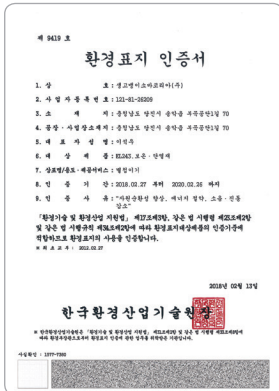

EPD

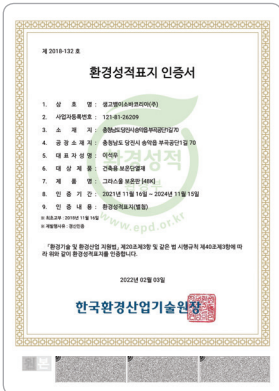

Good Recycled Certification

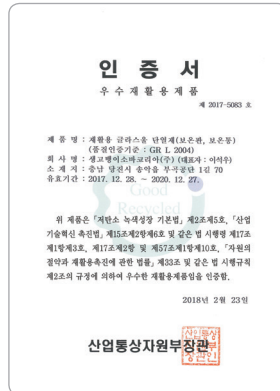

KS

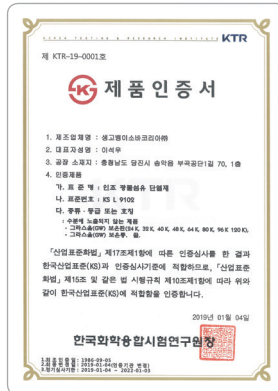

ISO9001



ISO14001



OHSAS 18001



BV Marine Certification



Glasswool is a harmless construction material whose safety has been proven worldwide.

International Agency for Research on Cancer Official Presentation

Group	Carcinogenicity evaluation	Materials
Group1	The agent is carcinogenic to humans	87 types including asbestos, tobacco, and cadmium, etc.
Group2A	The agent is probably carcinogenic to humans	63 types including UV rays and diesel exhaust gas, etc.
Group2B	The agent is possibly carcinogenic to humans	234 types including coffee, urethane, and styrene, etc.
Group3	The agent is not classifiable as to carcinogenicity to humans	493 types including glass wool, mineral wool, polyethylene, tea, etc.

In developed countries such as the United States and Europe, glass wool is widely used due to its safety, excellent performance of insulation, sound absorption, and non-combustible. This market share means that glass wool has already been verified as the safest material in advanced countries.

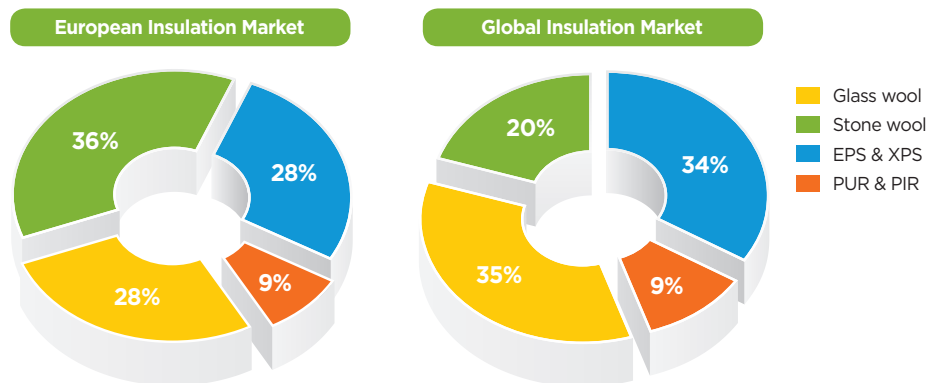

[Data source] Ceresana Market Research

References



**MAKING
THE WORLD
A BETTER
HOME**

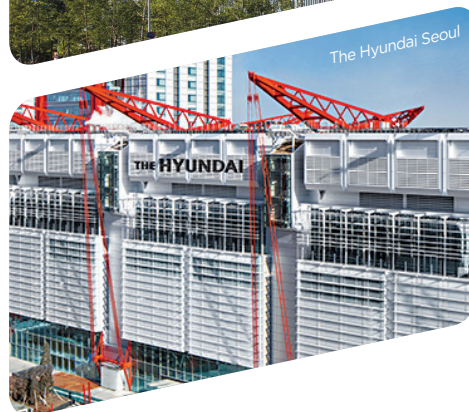



Saint-Gobain Isover Korea Co., Ltd

Seoul Office

12F, Teheran-ro 427, Gangnam-gu, Seoul
Tel : 02-3706-9112 Fax : 02-3706-9001

Dangjin Plant

70, Bugokgongdan 1-gil, Songak-eup, Dangjin
Tel : 041-351-4112 Fax : 041-357-4395

www.isover.co.kr